

EASYSOL – INSTALLATION MANUAL



Product description :
EASYSOL wall mounted umbrella



STEP 1 - Installation of supporting arm

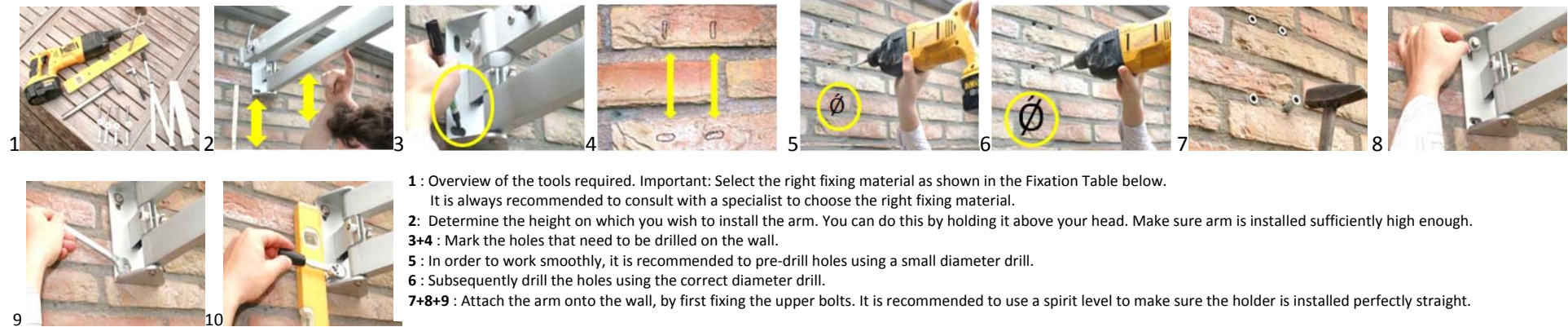

- 1** : Overview of the tools required. Important: Select the right fixing material as shown in the Fixation Table below. It is always recommended to consult with a specialist to choose the right fixing material.
- 2** : Determine the height on which you wish to install the arm. You can do this by holding it above your head. Make sure arm is installed sufficiently high enough.
- 3+4** : Mark the holes that need to be drilled on the wall.
- 5** : In order to work smoothly, it is recommended to pre-drill holes using a small diameter drill.
- 6** : Subsequently drill the holes using the correct diameter drill.
- 7+8+9** : Attach the arm onto the wall, by first fixing the upper bolts. It is recommended to use a spirit level to make sure the holder is installed perfectly straight.

STEP 2 – Installation of umbrella to supporting arm

METHOD 1 (11-14) Does not allow support arm to retract; Using this method, you need to take out the umbrella in order to close it.

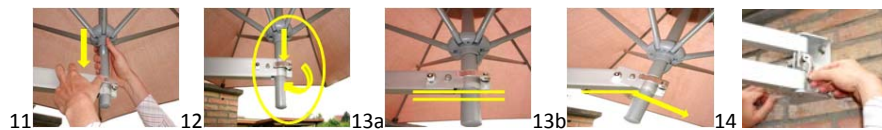

- 11** – Open the holder, by loosening the fastener and put the open umbrella in the open holder.
- 12** – Install the umbrella at the desired position and tighten the holder by closing the fastener.
- 13a** – The umbrella can be positioned horizontally
- 13b** – The umbrella can be tilted (open tilting mechanism and tilt, tighten in desired tilt position)
- 14** – Always tighten arm by fixing the levers in the desired position and avoid arm from swinging

METHOD 2 (15-26) – Allows support arm to retract; Using this method, you can close the umbrella on the umbrella holder by using the zip

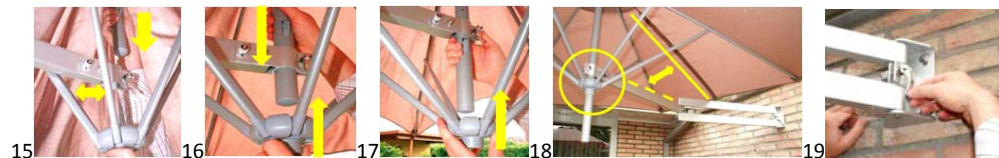

- 15** – Put the closed umbrella with the pole from the top into the holder, positioned in between the top and the crown of the umbrella
- Before implementing step 15, ENSURE the zip is positioned alongside the arm (see picture 18), to enable proper closing of the umbrella in steps 20 to 26
- 16/17/18** – push umbrella into & through the holder, pushing the holder upwards till above the clip
- 19** – Always tighten arm by fixing the levers in the desired position and avoid arm from swinging

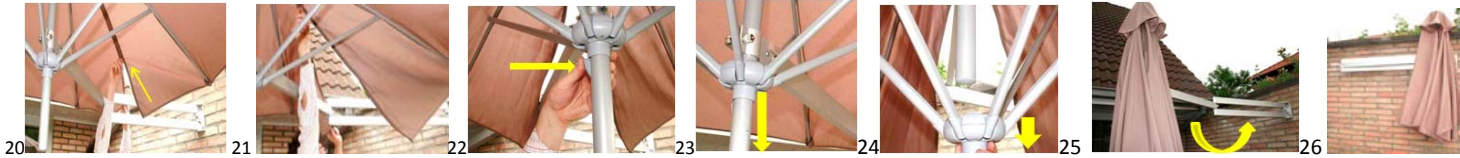

Closing the umbrella on the umbrella holder

- 20/21** – Open zip completely
- 22** – push the umbrella clip inwards to lower the umbrella frame
- 23/24** – pull the umbrella frame downwards and fold umbrella together
- 25/26** – close the arm

WARNING

- When installing and using this product, basic safety precautions should always be followed to reduce risk of personal injury and damage to equipment;
- Please carefully read all instructions before installation and use;
- Some parts may contain sharp edges, wear protective gloves if necessary;
- Keep children away from installation area;
- This umbrella with wall fixation is intended for sunshade purposes and is not meant to withstand inclement weather including high winds, rain and snow;
- Check all 'nuts and bolts' for tightness before and during usage;
- Make sure the wall is solid and strong enough to support the entire umbrella structure.
- The mounting hardware should be appropriate for your specific type of wall. Different wall construction materials require specific mounting hardware. The mounting hardware shown in the installation manual is for example only. If you are unsure of the correct type of mounting hardware for your application, please consult a specialist at your local hardware store.
- The manual is an example only and colour of your umbrella canopy might be different to what is shown in the picture.
- The manufacturer and retailer of your EASYSOL umbrella is not liable for damage caused by incorrect installation or wrongful use of it's product.

CARE & MAINTENANCE

- Fabric should be cleaned regularly before substance such as dirt, soot, roof particles, etc are allowed to accumulate and become embedded in the fabric. The fabric can be easily cleaned without being removed from the umbrella, simply brush off any loose dirt particles. Hose down and only sponge clean with a solution of mild natural soap and luke warm water. Never use harsh chemicals. Open the umbrella and allow to air dry .
- We recommend the umbrella is removed while not in use or covered with an umbrella cover.
- Never store the umbrella in a damp condition. Make sure the fabric is absolutely dry before storing it for winter.

FIXATION TABLE

CONCRETE	HEXAGONAL HEAD SCREWS FOR CONCRETE - Ø 8 mm
WOOD	HEXAGONAL HEAD WOOD SCREWS - Ø 8 mm
METAL	HEXAGONAL HEAD SCREWS FOR METAL – SCREW THREAD OVER FULL LENGTH - Ø 8 mm
ROBUST BRICK	EXPANDING WALL ANCHORS & HEXAGONAL HEAD SCREWS - Ø 8 mm or dynabolts